

OS LINUX

Connecting Printers

- Navigate to **System** → **Printers** unlock **padlock**, if necessary and click on **Add** or +

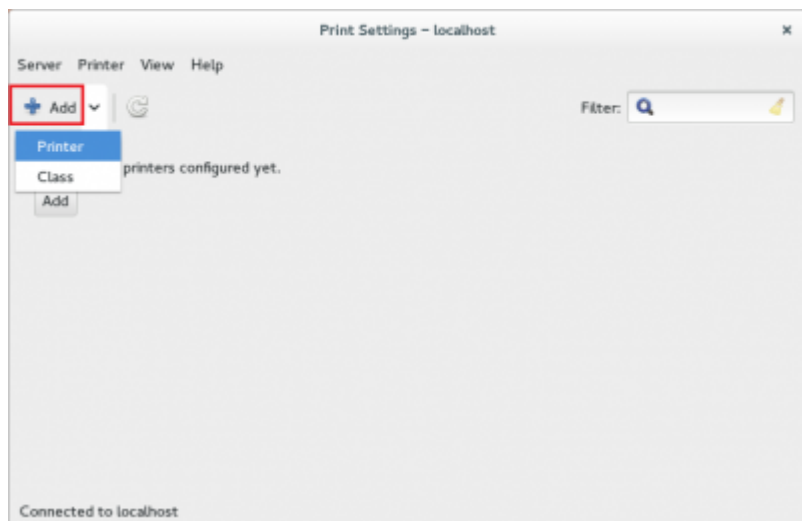

- Select **Windows Printer via Samba** option and on field **SMB Printer** enter a Device URL, such as **smb://rov-services.unitn.it/PrinterName** (es: PF_CC_p2_UffICT_Nero).
- On **Authentication** section check **Set authentication details now** and enter your **Unitn account** in this way **UNITN\accountname**

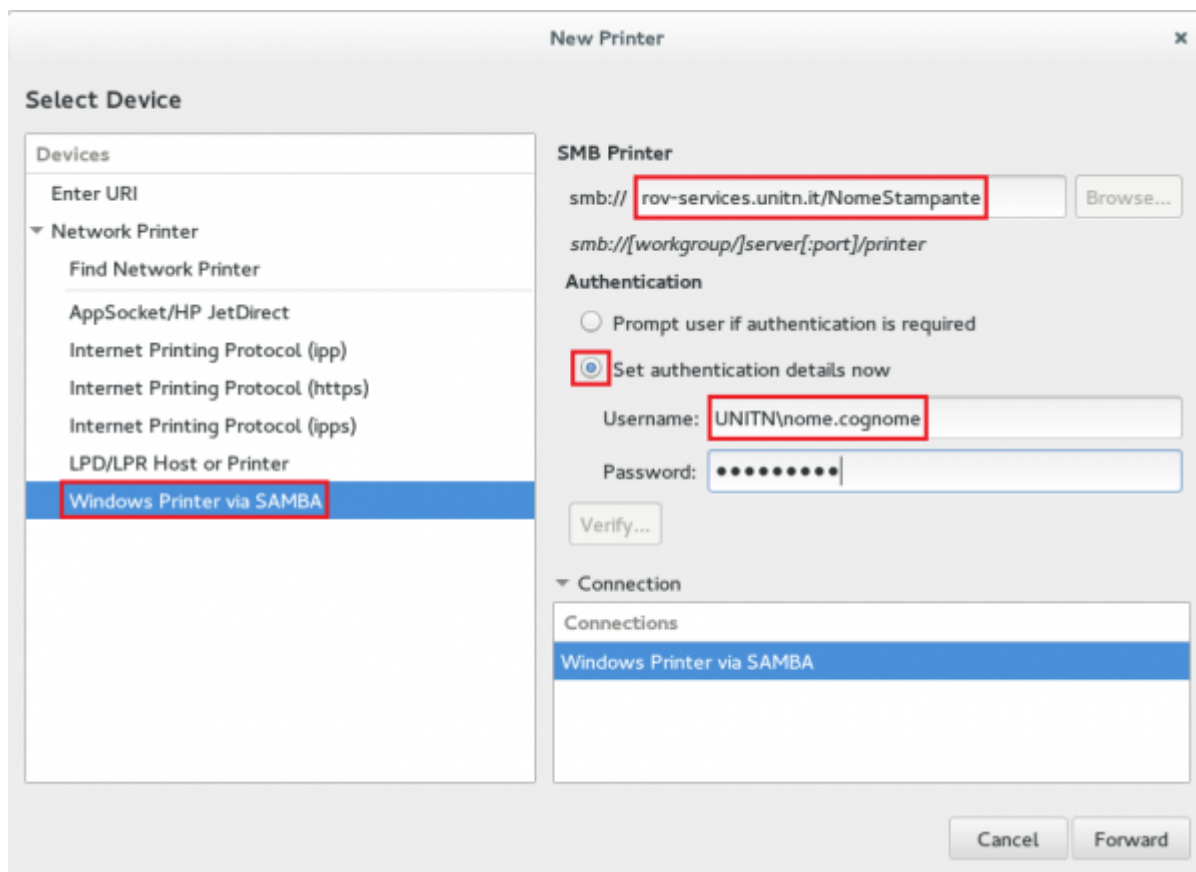

NOTE: If you do not have the installation options as shown, it is necessary to install a package in the distribution.

- Fedora/CentoOS/RedHat: the package is **system-config-printer**: from the terminal with root permissions **#yum install system-config-printer** and then lunch the command **#system-config-printer**
- Ubuntu: does not need additional packages

Choose **brand, model** of the printer and the **driver**. Insert the **Name, Description** and **Postion** if you want. Before testing your printer check in the **Properties** that the paper is set to **A4**.

N.B.: Changing the UNITN password involves the reconfiguration of the **Device URI** when open the **Properties** of the printer. After resetting the password you must reentered the entire URI described in the previous section (**SMB Printer smb://rov-services.unitn.it/PrinterName**) thus bringing back yours Unitn **credentials** as **UNITN\username**

From:
<https://wiki.unitn.it/> - **Wiki UniTn**

Permanent link:
https://wiki.unitn.it/pub:print_rovereto_linux

Last update: **2015/04/22 08:54**

